

# Cherry Grove Blind Valley SNA

Fillmore County



# Cherry Grove Blind Valley SNA

Fillmore County

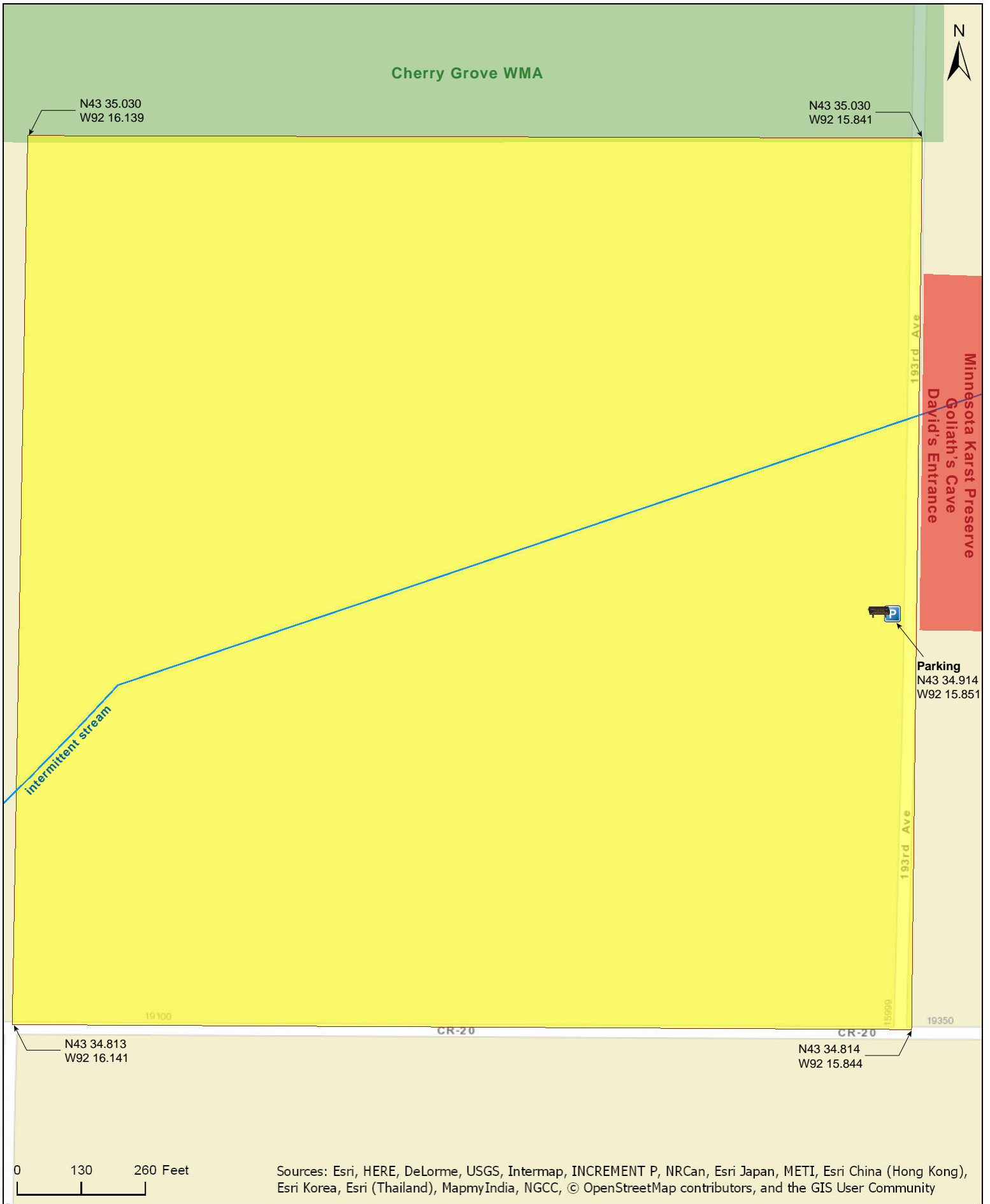

Sources: Esri, HERE, DeLorme, USGS, Intermap, INCREMENT P, NRCan, Esri Japan, METI, Esri China (Hong Kong), Esri Korea, Esri (Thailand), MapmyIndia, NGCC, © OpenStreetMap contributors, and the GIS User Community

# Cherry Grove Blind Valley SNA

Fillmore County





# Cherry Grove Blind Valley SNA

## Directions and Notes from Minnesota DNR

**Directions:** From Cherry Grove 0.5 mile S on Co Rd 5 then 1.25 miles E on Co Rd 20, then 0.1 mile N on Twp Rd 379. Park on W road shoulder.

**Lat/Lon:** 43.581912, -92.264184

Sanctuary (below ground portion closed). This site has no recreational facilities. Cherry Grove WMA is adjacent to this site. See detail map for locations of interpretive signs.

## Notes from MinnesotaSeasons.com

### **Parking**

N43 34.914, W92 15.851

This SNA is just south of Forestville/Mystery Cave State Park. It is bordered to the north by the Cherry Grove State Wildlife Management Area. Just across the road (193rd Avenue) from the parking spot is the privately owned Minnesota Karst Preserve, Goliath's Cave section.

The protected feature of this SNA is the underground cave system, which connects to caves in Forestville State Park. Access to the gated cave system for qualified spelunkers requires written permission. The only above-ground feature mentioned by the Minnesota DNR on their Web page for this SNA are "sinkholes filled with scrub trees." The non-wooded portion of the site is an agricultural meadow – it is mowed every summer.

## DISCLAIMER OF WARRANTIES AND LIMITATIONS OF LIABILITY

MinnesotaSeasons.com, The Nature Conservancy, U.S. Department of Agriculture, Forest Service, U.S. Fish and Wildlife Service, the state of Minnesota, the Minnesota Department of Natural Resources, and their employees, make no representations or warranties, express or implied, with respect to the use of or reliance on the data provided herewith, regardless of its format or means of transmission. There are no guarantees or representations to the user as to the accuracy, currency, completeness, suitability or reliability of this data for any purpose. **THE USER ACCEPTS THE DATA AND/OR SOFTWARE "AS IS" AND ASSUMES ALL RISKS ASSOCIATED WITH ITS USE.**

**IN NO EVENT SHALL MINNESOTASEASONS.COM, TNC, USDA-FS, USFWS, OR MNDNR BE LIABLE FOR ANY DIRECT, INDIRECT, INCIDENTAL, SPECIAL, EXEMPLARY, OR CONSEQUENTIAL DAMAGES (INCLUDING, BUT NOT LIMITED TO, PROCUREMENT OF SUBSTITUTE GOODS OR SERVICES; LOSS OF USE, DATA, OR PROFITS; OR BUSINESS INTERRUPTION) HOWEVER CAUSED AND ON ANY THEORY OF LIABILITY, WHETHER IN CONTRACT, STRICT LIABILITY, OR TORT (INCLUDING NEGLIGENCE OR OTHERS) ARISING IN ANY WAY OUT OF THE USE OF THIS DATA, EVEN IF ADVISED OF THE POSSIBILITY OF SUCH DAMAGE OR FOR ANY CLAIM BY ANY OTHER PARTY.**

Your use of the data is acceptance on your part of the terms and conditions set forth herein.