

Hemlock Ravine SNA

Carlton County





Hemlock Ravine SNA

Carlton County

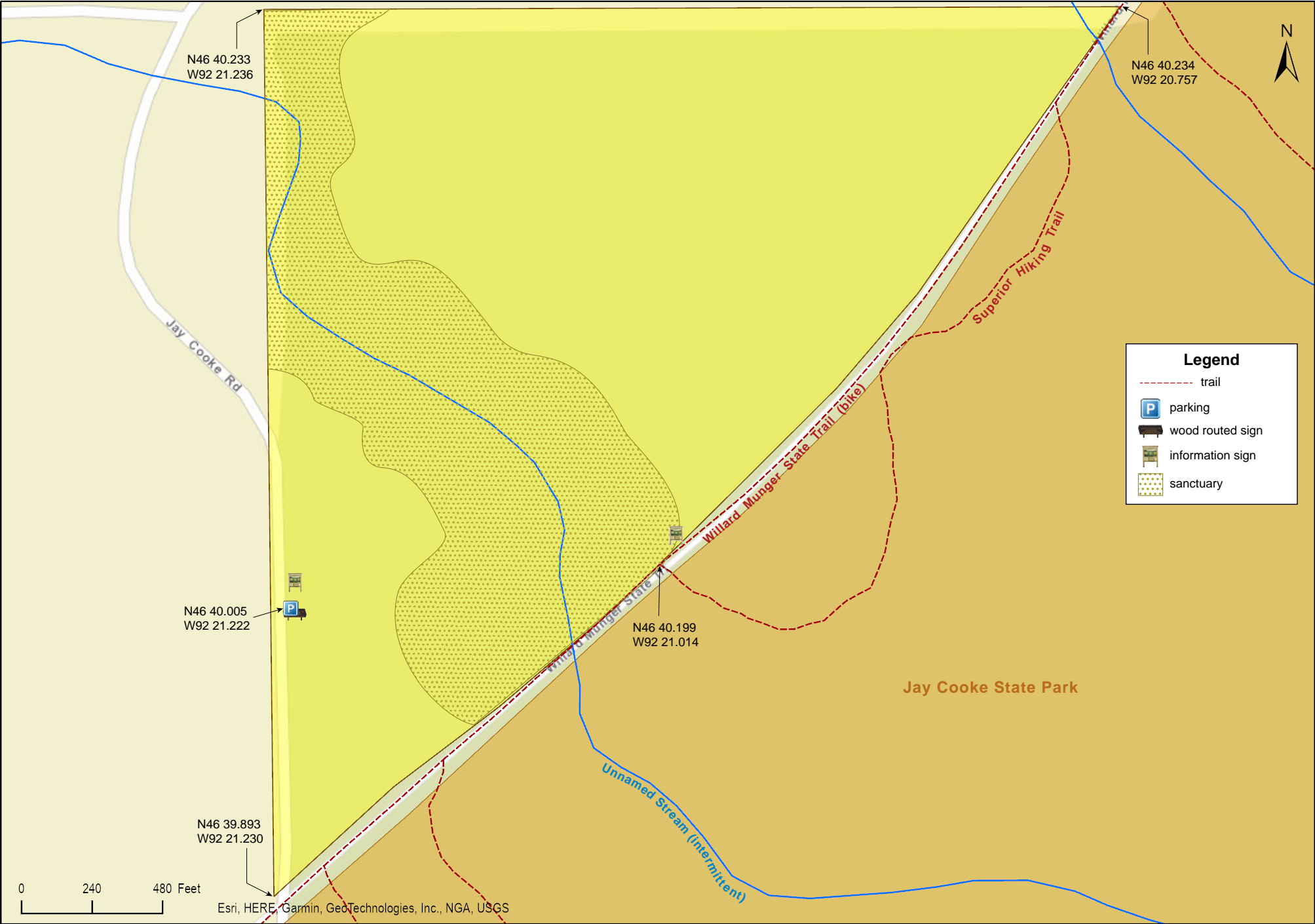

Hemlock Ravine SNA

Carlton County





Hemlock Ravine SNA

Carlton County

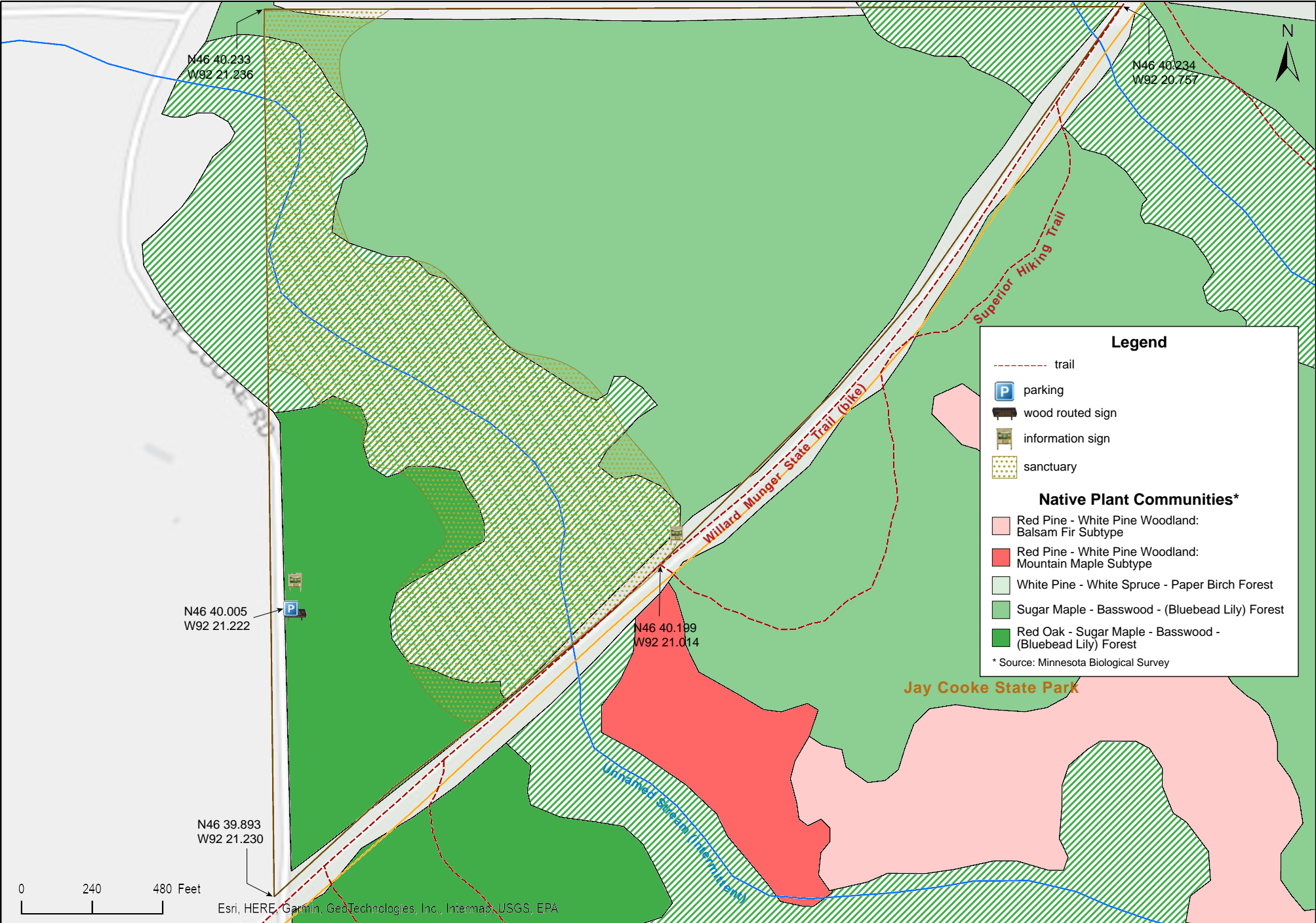







# Hemlock Ravine SNA

## **Directions and Notes from Minnesota DNR**

### **Directions**

From Esko, 2.2 miles S on Co Rd 1 (Thompson Rd), then 1.0 mile E on E Palkie Rd, then 0.75 mile S on Co Rd 151 to parking area on E.

### **Lat/Lon**

46.666719, -92.353678

Sanctuary (posted sanctuary portions closed). The Willard Munger State trail is adjacent to site, see detail map. Recreational facilities available in Jay Cooke State Park.

## **Notes from MinnesotaSeasons.com**

### **Parking**

There is a parking area on the east side of Jay Cooke Road.  
N46 40.005, W92 21.222

### **Hiking Trails**

The Willard Munger State Trail forms the long southeast border of this triangular SNA. Parts of this section of trail are shared with the Superior Hiking Trail.

### **Sanctuary**

The sanctuary portion of this site is closed to protect rare and sensitive resources. It splits the site in half north to south. Parking is on the west section. The east section can be accessed from the Willard Munger State Trail.

## **DISCLAIMER OF WARRANTIES AND LIMITATIONS OF LIABILITY**

MinnesotaSeasons.com, The Nature Conservancy, U.S. Department of Agriculture, Forest Service, U.S. Fish and Wildlife Service, the state of Minnesota, the Minnesota Department of Natural Resources, and their employees, make no representations or warranties, express or implied, with respect to the use of or reliance on the data provided herewith, regardless of its format or means of transmission. There are no guarantees or representations to the user as to the accuracy, currency, completeness, suitability or reliability of this data for any purpose. THE USER ACCEPTS THE DATA AND/OR SOFTWARE "AS IS" AND ASSUMES ALL RISKS ASSOCIATED WITH ITS USE.

IN NO EVENT SHALL MINNESOTASEASONS.COM, TNC, USDA-FS, USFWS, OR MNDNR BE LIABLE FOR ANY DIRECT, INDIRECT, INCIDENTAL, SPECIAL, EXEMPLARY, OR CONSEQUENTIAL DAMAGES (INCLUDING, BUT NOT LIMITED TO, PROCUREMENT OF SUBSTITUTE GOODS OR SERVICES; LOSS OF USE, DATA, OR PROFITS; OR BUSINESS INTERRUPTION) HOWEVER CAUSED AND ON ANY THEORY OF LIABILITY, WHETHER IN CONTRACT, STRICT LIABILITY, OR TORT (INCLUDING NEGLIGENCE OR OTHERWISE) ARISING IN ANY WAY OUT OF THE USE OF THIS DATA, EVEN IF ADVISED OF THE POSSIBILITY OF SUCH DAMAGE OR FOR ANY CLAIM BY ANY OTHER PARTY.

Your use of the data is acceptance on your part of the terms and conditions set forth herein.